



ALKALIZING
IONIZING
SUPER HYDRATING
ANTIOXIDANT
WATER FILTER



Naturally Ionized Pure Water

alkaStream produces ionized water the same way nature does, by flowing water through mineral-rich filter layers. Healthy, delicious, affordable, eco-friendly water straight from your tap! It's energy efficient - *no electricity required ... and no more plastic bottles to 'recycle'.*



USER MANUAL

The Ultimate *Antioxidant*
Water Filter!

More than a filter...
More than an ionizer.



CONTENTS

Installation Notices	3
Assembly	
Connect to the Faucet	4
Connecting Flow Valve	4
Filter Components	5
Changing the Filter	6
Specifications	6
Warranty	6
What to Expect	7
Daily Use	7
The alkaStream Vision	8

©2010 AlkaWay 11.10

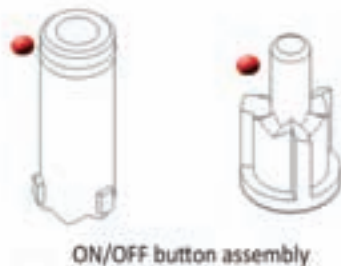

NOTE: Australian water pressure conditions dictate that the top ON/OFF switch has been disabled.

alkaStream SCHEMATIC DIAGRAM

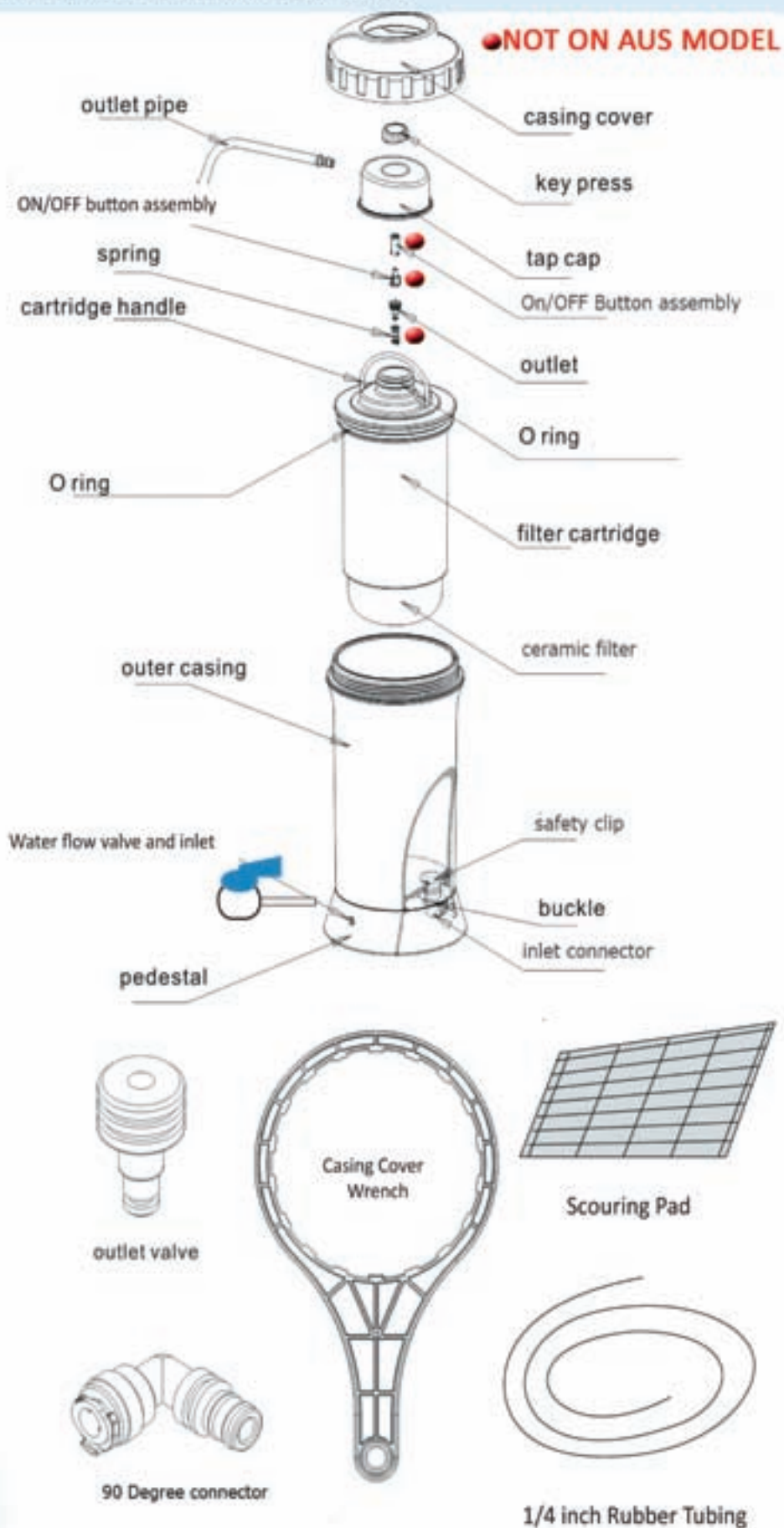

Installation Notices and Expectations

PLEASE READ THIS MANUAL BEFORE ASSEMBLY AND USE OF YOUR alkaStream!



- Locate your alkaStream close to your faucet or sink.
- Avoid locating your alkaStream unit or the inlet hose close to a heat source to prevent melting. Never place the alkaStream in a freezer.
- Do NOT run hot water through alkaStream. Fittings are not designed for excessive heat.
- Upon completion of assembly, you must run approximately 30 liters of water through your alkaStream (10 minutes at a fast flow rate) to hydrate the media and to flush out any loose carbon particles.
- The rate of water flow into your alkaStream is critical to performance of the machine in terms of both filtration and ionization. The optimal water flow rate for your alkaStream is 0.8 to 1.0 liters per minute. In order to determine the proper flow rate, fill a 250ml glass in 15 seconds.
- Adjust the flow rate with the flow valve that comes attached to your alkaStream. Adjust the flow valve by rotating the blue lever until the desired flow rate is achieved. Once you have established the ideal water flow rate of 1.0 liter (1 quart = 32 ounces) per minute, you can leave the blue lever set at that position and your alkaStream will always run at the ideal flow rate. See diagram below.



- Although there is an ON/OFF switch on the top of your alkaStream, we have disabled it to cope with the widely fluctuating water pressure found in Australia. This means you control water flow by simply turning on your faucet to the maximum.
- When cleaning the outer casing of your alkaStream, use only soap and warm water. Do NOT use alcohol or any abrasive cleaning products.

- Your alkaStream is capable of running for up to 30 minutes without significant reduction in its ability to supply excellent pH and ORP results. After 30 minutes of use of your alkaStream, performance will diminish. Therefore, limit the length of use to less than 30 minutes and then give your alkaStream at least 5-10 minutes 'rest' before re-use.

- The ceramic portion of your filter located at the bottom of the filter may collect sediment from your source water over time. This may reduce the rate of water flow. If you find the water flow rate slowing down, clean the ceramic portion of your filter as per the 8 Easy Steps to Clean or Replace the alkaStream Filter found on page 6.

- Because alkaStream is always ionizing and creating energized water, your first 'shot' in the morning may have a mineral taste. It is recommended to let the water run for ten (10) seconds each morning to clear the "strong" water out of your alkaStream.

- The filter in your alkaStream should be replaced every six months or after processing 5,000 liters of water, whichever comes first. Changing the filter after six months allows your alkaStream to provide the exceptional filtration that you will become accustomed to.

- Your AlkaStream will 'dribble' and splutter for the first 20+ uses. This is because an air bubble is trapped in the chamber. It will dissipate with use and the splutter and dribble will dissipate with it. From that point you can expect fast flow and clean stop.

- **Disclaimer:** Follow the installation instructions in this Manual when installing your alkaStream. Failure to follow the instructions may cause damage or leakage that will be your responsibility. The manufacturer and distributors will not be responsible for incorrect, or negligent installation, or ignoring the instructions in this manual.

ASSEMBLING the alkaStream

The alkaStream is a 'state of the art' 8-stage water filtration and ionization system, designed to provide you with years of clean, pure, alkaline, ionized water.

Connecting Your alkaStream to Your Tap.

STEP 1: Disconnect aerator from your faucet outlet. (Fig. 1)

STEP 2: Connect diverter valve to tap head. (Fig. 2) Additional adaptors are supplied in the 'Alkaline Ionizer Accessories' box.

STEP 3: Connect one end of the plastic hose to the diverter outlet and screw it on tightly. (Fig. 3)



STEP 4: Insert the supply hose into the water flow valve. (Fig. A)

A



Note 1: When you are setting up your alkaStream, simply push the 1/4 inch white hose into the compression fitting of the water flow valve. Hold the flow valve in one hand and push the hose into the compression fitting with your other hand. You will feel an initial resistance when you first push the hose into the compression fitting. However, keep pushing until you feel the fitting grab the hose so that it fits snugly into the compression fitting.

Note 2: In the event that you have to remove the 1/4" hose from the water flow valve, use your finger tips to press the white ring located at the point where the hose meets with the water flow valve towards the water flow valve. At the same time, use your other hand to pull the hose away from the water flow valve.

STEP 5: Insert stainless steel outlet pipe into top cap.

STEP 6: Turn on your faucet, turn the diverter valve to the 9 o'clock horizontal position to allow water to flow to your AlkaStream

STEP 7: Button on top has been disabled for Australian conditions.

Note: The initial flow may be under high pressure and subject to a small burst of water. This may occur for up to 20 first uses.

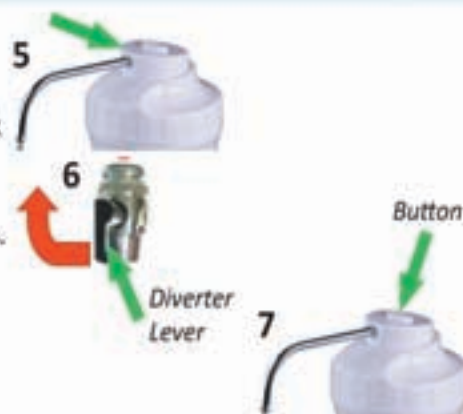

Filter Components



Filter Components and Their Function

The alkaStream filter is "eco-friendly" and provides superior filtration to any of the leading water ionizers available for sale on the market. The following is a list of the composition and function of each layer of filtration.

1 > Ceramic Filter Membrane stops all sediment, and bacteria over 0.2 microns in size.

2 > Ion Exchange Media (NSF approved) reduces hard water and eliminates fluoride. *NSF is a non-profit organization which promotes and supports research and education in the sciences.*

3 > Catalytic Carbon reduces organic contaminants, color, odor, taste, pesticides, THMs, chlorine, chloramine and VOCs.

4 > KDF and Magnesium in a catalytic carbon media removes heavy metals such as lead and mercury.

5 > Energizing Media creates anti-oxidants, hydroxyl ions and free-hydrogen.

6 > Trace Minerals and Far Infrared ceramics adds more than 70 beneficial trace elements.

7 > Activated Carbon and KDF to improve final taste and remove unwanted non-beneficial trace elements.

8 > Neodymium Magnetic Field to stabilize the IONIC charge and reduced molecular size.

Periodic Cleaning of the Ceramic Filter

When the outflow of filtered water decreases or stops completely, this may indicate that the ceramic filter in the cartridge is partially OR fully covered with sediment, making it difficult for water to pass through the alkaStream. The ceramic filter will need to be cleaned.

Note: Use the soft scouring pad provided. You need only remove the outer surface sediment. Do NOT use a hard toothbrush or metal scouring pads as these can damage the Ceramic Filter.

Only clean the Ceramic Filter of the Filter Cartridge with running tap water. DO NOT soak in any detergents or wash with any detergent-based products. See page 6.



How does your alkaStream Compare with Electronic Water Ionizers?

When water flows through the filter in your alkaStream, the water is cleansed of bacteria, fluoride, chlorine, lead, mercury, VOC's and other substances. Most water ionizers only eliminate chlorine. No water ionizer on the market comes close to offering the filtration of your alkaStream.

When water is passed through the natural media found in your alkaStream, the water will have pH and ORP levels consistent with the results produced from the drinking levels of all of the leading water ionizers. In addition, your alkaStream creates stable free-hydrogen that is recognized as a powerful antioxidant.

Scale buildup from precipitation of calcium out of hard water during electrolysis is the primary source of problems for water ionizers. Your alkaStream will never have this problem.

Unlike water ionizers which have platinum covered titanium plates that degenerate over time as the machines are used, your alkaStream becomes virtually *brand new* every time you change the filter.

Changing the Filter

B

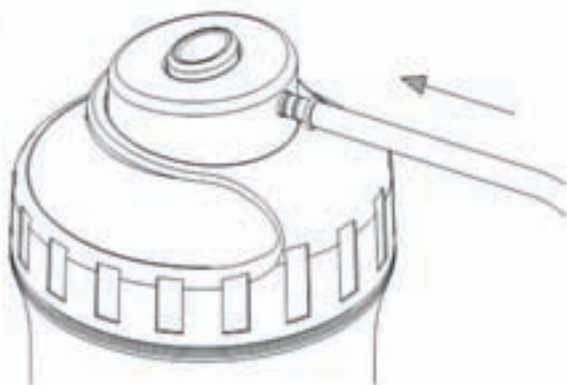

C

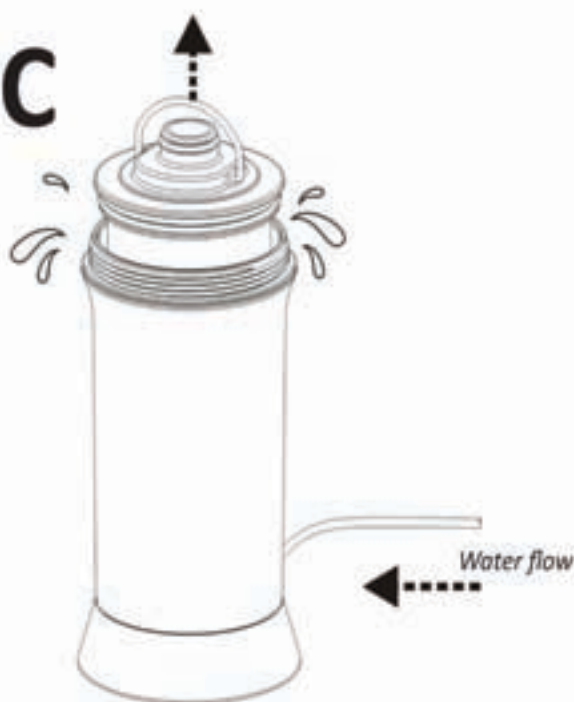

D

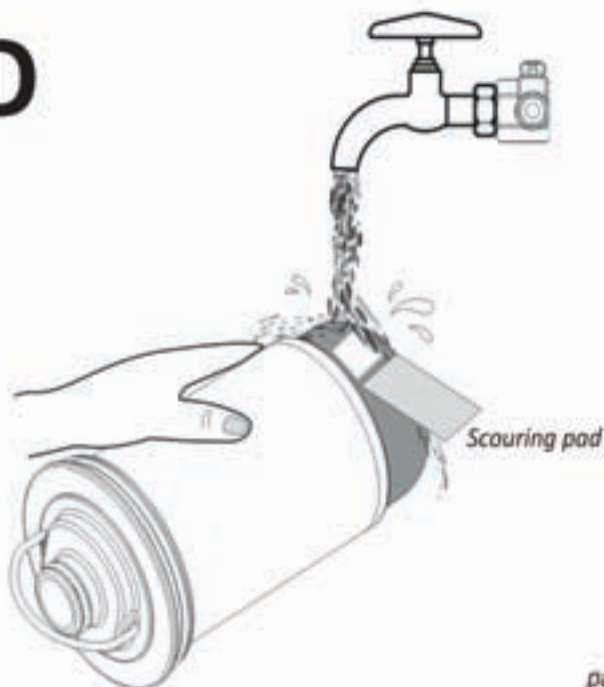

Replacing the Filter Cartridge

The filter in your alkaStream has been designed to last 5,000 liters or six months, whichever comes first. Your filter is very efficient at removing contaminants, but after six months, it may begin to release the stored up contaminants back into the water.

Note: this always depends on incoming water quality and usage volume. If the ceramic filter shows breaks or cracks due to wear and tear, or if filtered chlorinated water begins to smell or taste of chlorine, it is time to replace the filter cartridge.

8 Easy Steps to Clean or Replace the alkaStream Filter

1. Turn off the water supply to the alkaStream.
2. Pull out the Outlet Pipe from the Top Cap (Diagram B).
3. Turn casing cover counter-clockwise to loosen. You may need to use the supplied ring spanner.
4. Remove Top Cap.
5. You can remove the filter by holding the canister in one hand and pulling the filter out of the canister using the silver handle. This is best achieved by applying steady pressure upwards on the handle while gently rocking the handle back and forth.

Alternative Method: If you are unable to remove the filter using this method, you can use the force of the tap water to push the filter out of the canister. Turn ON tap water (and fully open valve) and it will push filter cartridge up and out. (Diagram C). Turn OFF the tap water as soon as the filter is dislodged from the canister.

6. To cleanse ceramic filter only, take cartridge out and clean with the scouring pad provided. (Diagram D)
7. Replace or reinstall the cartridge. Flatten handle.
8. Finally, reattach the top cap and screw on the Casing Cover clockwise. Reconnect the Outlet Pipe and make sure that the flow valve is still set to allow a water flow rate of 1 liter per minute.



Specifications

Warranty

Your alkaStream is guaranteed against defects caused by the manufacturer. The outer cartridge, the switch mechanism, and the pressure relief valve are guaranteed for normal home use for 2 Years. *Please keep your invoice for warranty claims.*

Output Flow Rate	1 liter/min	1 qt/min
Inflow water pressure	0.1 - 0.4 MPa	14.5 - 58 PSI
Water inflow for optimal operation	6.8 - 7.2 pH	6.8 - 7.2 pH
Water inflow temperature range	2° - 40° C	35° - 104° F
Dimensions (diameter x height)	13 _{mm} x 36 _{mm}	5.1 _{in} x 14 _{in}
Weight	3.5 kg	7.7 lbs
Waterproofing Standard	Px-1	Px-1

Laboratory Test Results

In a special laboratory-created "witches brew" of pesticides, volatile organics, fluoride, chlorine, and minerals, the alkaStream changed the pH from 6.5 to 9.5 and the ORP from +495 to -243. Please be aware that the pH output is always dependent upon the mineral composition of the source water. The advantage of the alkaStream is that in areas of hard water with excessive levels of alkaline minerals, it will reduce these minerals and then re-infuse the water with lower, healthier levels of alkaline minerals (as well as micro clustering and ionizing the water). In areas of soft water, it will add healthy alkaline minerals to raise the pH to the alkaline range.



What to expect as you start drinking alkaStream water

Initial Detoxification Issues:

When you first start drinking alkaStream water, you may experience mild forms of detoxification. You may experience headaches, cold or flu like symptoms, or diarrhea in more severe cases. The detoxification symptoms may last until your body has had a chance to fully release the toxins stored in the cells of your body. If symptoms persist, contact your medical practitioner.

During the first week, consume the same amount of alkaStream water as you have of other types of water (tap, filtered, bottled, etc.) After the first week, begin to drink one extra glass of alkaStream water per day. The following week, begin to drink two extra glasses of water per day. Continue increasing your intake until you are drinking the amount of water appropriate for your body each day (on average 8 glasses per day.)

Beneficial Effects. You may also experience immediate cessation of some poor health conditions. Alkaline ionized water is a powerful deacidifier, detoxifier, hydrator and antioxidant.



Daily Use

After installation, turn on the tap and let the water run through the alkaStream for 10 minutes at full volume. The initial output water will be gray in color due to carbon dust being washed off the carbon in the filter. Once the output water runs clear, the filtered water can be used for drinking, washing or cooking.

When you turn off the flow at the tap, filtered water may still flow out for another 20-30 seconds. This is due to the residual pressure that has built up behind alkaStream's highly efficient "stage one" ceramic filter while it was in use.

If your alkaStream is left unused for a few days in a row, the initial water color upon startup may be slightly gray in color and have a strong taste. This is due to the fact that the water has been soaking in the media for a long period. Allow the water to run for a few minutes or until the color of the water is clear before using the water for drinking.

The alkaStream Vision

Millions of households drinking alkaStream water and enjoying ever increasing vitality and wellness.



In order to fulfill our vision, we have gone to great lengths to make sure that the alkaStream is the most effective and the most affordable Antioxidant Filter on the market.

Our customers often experience positive changes to their health within the first few weeks of using their alkaStream. Once they understand the benefits first hand, many want to share their positive results with family and friends.

We hope you will join us in our vision of spreading the word about the benefits of pure, healthy, alkaline water. In order to encourage you, we have established an Affiliate program that rewards people for making the effort to educate others about the benefits of the water. Please join our us in our efforts by signing up for our Affiliate program . It's easy to do and it's FREE. Every time you refer a family member or friend who buys an alkaStream, you will receive \$80. To learn more about our Affiliate program, please visit our website at:

<http://www.alkaway.com.au>
and click on 'Join Us'



FILTER REPLACEMENT

To sustain the ability of the alkaStream to produce pure, alkaline, ionized water, the filter must be replaced every six months. To order replacement filters, please visit our website at:

<http://www.alkaway.com.au/products-alkastream.html>

alkaStream

www.alkastream.com | info@alkaway.com.au | (61) 02 6685 6471



Naturally Ionized and Eco-Friendly

alkaStream produces ionized water the same way nature does, by flowing water through mineral-rich filter layers. The alkaStream uses renewable KDF and ceramic technology that extends filter life. It's energy efficient - *no electricity required ... and NO MORE plastic bottles to 'recycle'.*