



ALKAWAY

THE ULTIMATE WAY TO GOOD HEALTH

AlkaLina
Hydrogen
Rich
Water and
Alkaline
Water
System
manual:
Reverse
Osmosis
Add-on.

**KEEP IT
HANDY**

AlkaLina Installation: RO

Congratulations on choosing the AlkaLina alkaline and hydrogen generating water system to be added to your Reverse Osmosis water filter.

By following the steps in this instruction sheet we know you'll be able to have the best of both worlds - pure water - and superb hydrogen rich alkaline water.

Here's what we're going to do.

We are going to install the two AlkaLina filters between your Reverse Osmosis system and your faucet. Because there are so many Reverse Osmosis systems on the market, we will try to reduce installation steps to the basic ones that apply to all RO's.

WHERE ARE WE PUTTING IT? See the blue circle below.

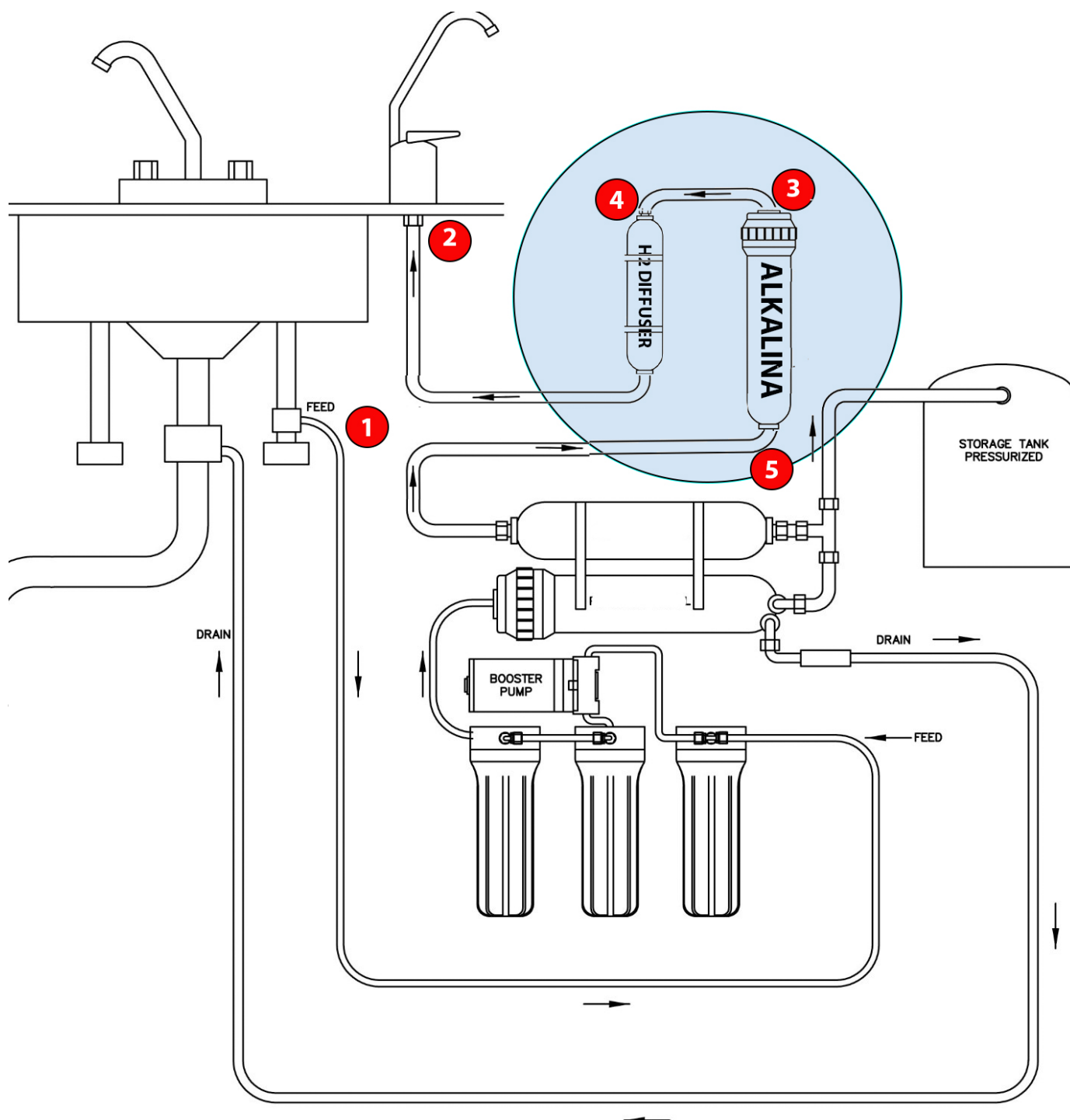

How To Cut Tubing for John Guest Fittings

1. Use a very sharp knife or razor blade to get a clean right angle cut.
2. Check to make sure you have a **nice clean & even end**.

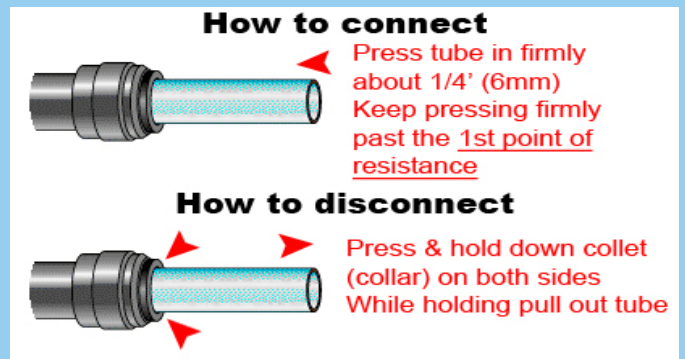
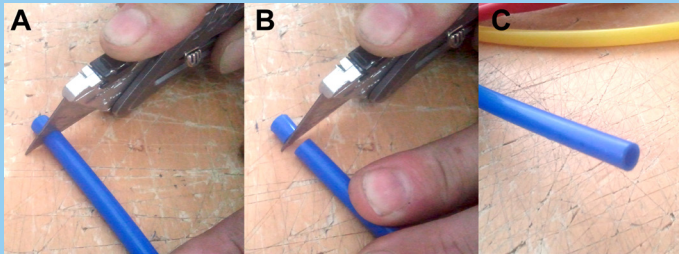

A Friendly Hint:

If it looks too hard, maybe it is. Sometimes your original system has been installed in a way that it takes up most of the room undersink. Find a handy friend or a good plumber familiar with Reverse Osmosis systems.

What You've Received:

- ✓ 1. AlkaLina Cartridge with Quickfit connectors top and bottom
- ✓ 2. H2 Diffuser with Quickfit connectors top and bottom.
- ✓ 3. Clips to mount filters
- ✓ 4. 1/4" Hose.
- ✓ 5. pH Reagent
- ✓ 6. Spanner



- 1 Turn off your mains water at the tap feeding the RO. This will be under the sink on your cold water feed pipe. (See RED '1' on diagram). Turn ON your benchtop faucet.
- 2 Determine where you want to install the two filters. Make locating marks and mount the clamps for the filters.
- 3 Locate the hose from the RO to the faucet. To locate this go to the underside of the faucet and trace the hose back. Cut it close to the RO (or remove it from the RO)(See RED '2' on diagram)
- 4 Mount the filters in the clamps
- 5 Attach the faucet hose to the outlet point of the H2 filter. (See RED '3' on diagram)
- 6 Cut sufficient hose to go from the AlkaLina to the H2 cartridge inlet. Push hoses in hard, then push again to secure properly.. That's all you need to to make it watertight. (See RED '4' on diagram)
- 7 Cut sufficient hose to attach the RO to the inlet of the AlkaLina. (See RED '5' on diagram)
- 8 Turn on your cold water tap to resupply water to your RO. Check if there are any leaks in your connections. If so, turn off the cold water supply, turn on the faucet to relieve pressure. Remove the leaking hose, recut hose end square as shown above, and re-insert.
- 9 Turn on your cold water again and allow the water to flow through your benchtop faucet. Let it run for 5-10 minutes then turn off.

YOUR ALKALINA MAY 'SPUTTER' FOR SOME TIME WHEN TURNED ON. THIS DEMONSTRATES THAT THE HYDROGEN ENRICHED WATER IS BEING CREATED. TRY TO DRINK THIS 'FIRST SHOT'.

REMEMBER TO REGISTER YOUR ALKALINA FOR WARRANTY.

REPLACING YOUR ALKALINA CARTRIDGES

Helpful hint: Order your replacements before your system needs it. In that way you have a chance for a simpler changeover and no loss of precious AlkaLina water.

CHANGING YOUR FILTERS

Only the Alkalina - your first and biggest cartridge - has an internal filter. Only this cartridge needs to be removed, opened, and the inner alkalizer replaced.

- 1** Turn off your cold water inlet and turn on your faucet. This will reduce water pressure making your job easy.
- 2** Remove both hoses from the Alkalina cartridge.
To do so, push a fingernail against the collar close to the hose. Push first and pull the hose after. (Diagram top P2)
- 3** Remove the cartridge from its clamps. Using the large ring spanner provided, undo the top cap from the AlkaLina. (This may not be easy! Try wrapping a tea towel around the lower section while using the spanner on the top).
- 4** Thoroughly wash and dry the opened cartridge. Then insert the new alkaliser cartridge. Screw on the cap, and reattach it to the clamps.
- 5** Attach the hoses you removed earlier by pushing them hard into the connectors.
- 6** Repeat the removal process with the H2 Diffuser cartridge. You should now have all hoses reconnected.
- 7** Turn on the cold water inlet tap. Turn off the faucet. Check for leaks.
- 8** Turn on the faucet. Let the water run for a few minutes then turn off.

And now... Take another drink of hydrogen infused wonder water!

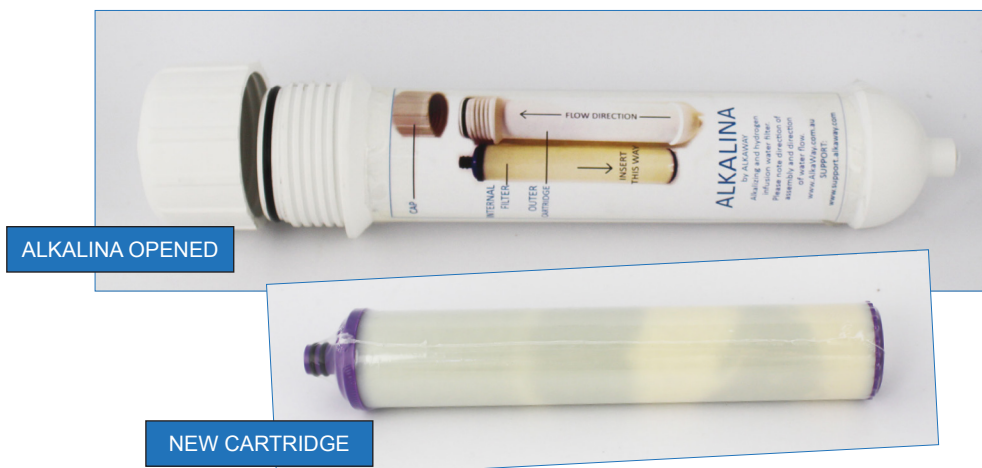

**ORDER YOUR
NEXT
ALKALINA
CARTRIDGE
SET or
REGISTER
YOUR
WARRANTY**

**PAY FOR YOUR
NEW FILTER
BY HELPING A
FRIEND.
Send us your
interested
friend's name
and earn
AlkaWay
credit!**

USA
www.alkaway.com
UK
www.alkaway.co.uk
AUSTRALIA
alkaway.com.au