

Congratulations on choosing the AlkaWay Undersink Kit for your UltraStream water system. By following the steps in this instruction sheet we know you'll be able to have the best of both worlds - fabulous UltraStream water - and clear benchspace, with a minimum of fuss.

We've designed this guide to be a step by step process. The first step is to check that you have everything necessary in your kit.

Check Your Kit Content



JOHN GUEST SIZE CONVERTER:
Connects UltraStream to the faucet via the BLUE hose. (should have a clear plastic sleeve fitted)



UNDERBENCH SPACER -ON FAUCET
(Tube colours shown for easy reference)



JOHN GUEST SPANNER
Used to REMOVE Size Converter to change filter.



PRESSURE LIMITING VALVE



MAINS CONNECTOR AND STOP VALVE

VENTED FAUCET

STEP ONE

Familiarize yourself with 'John Guest'. These are special patented connection tools that allow ultra-simple connection of hoses and pipes. To attach a hose, all you need to do is push the hose into the fitting.

To remove, all you need do is push on the collet (ring) around the hose and pull on the hose at the same time, using the John Guest Tool. (or fingernails)

The only important thing to remember is to ensure the end of the hose is cut cleanly and at right angles.

How To Cut Tubing for John Guest Fittings

1. Use a very sharp knife or razor blade to get a clean right angle cut.
2. Check to make sure you have a nice clean & even end.

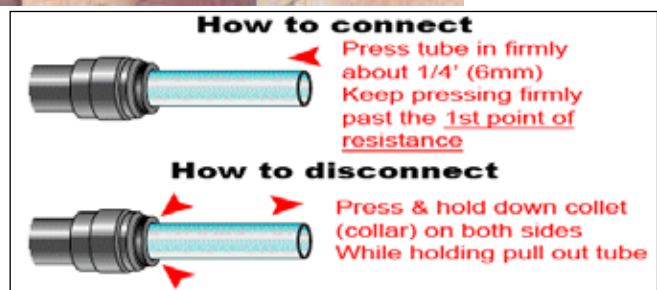
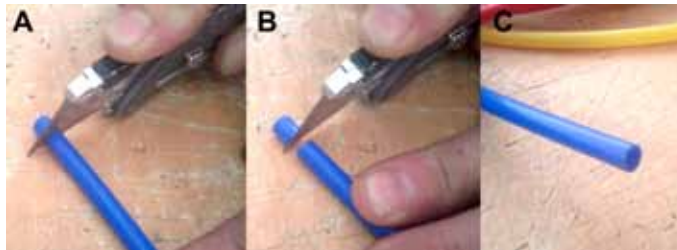

Next Step is to prepare your kitchen for installation.

Step 2: Disconnect Water Supply and Connect the undersink diverter.

1. Turn off the cold water using the shutoff valve below the sink or house water mains.
2. After shutting off the water open the kitchen faucet draining the remaining water out of the line. Turn on a (low) garden tap to drain the water line.
3. Below the sink place a container under the shut off valve and disconnect the cold water line.
4. Install the Cold water connector. (make sure it's turned OFF).
5. Reconnect cold water line.

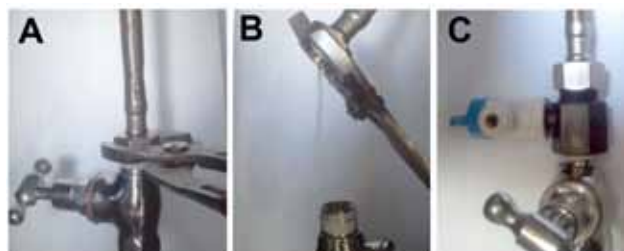

Now You're Ready To Install Your UltraStream

Step 3:

1. Take off the UltraStream spout by holding the round part of the spout and pulling upward.
2. Remove the cap and store.



Step 4: REMOVE BASEPLATE AND HOSE

Take off existing flow diverter and hose from the bottom of the UltraStream (see illustrations below AND the instructions on John Guest Connector Usage on previous page)



Step 5: Position and Drill the Vented Faucet Hole

Locate a position on the bench top which will ensure the UltraStream Vented Faucet spout can flow into the sink when running.

1. Drill $1\frac{1}{6}$ " to $1\frac{17}{64}$ " (30mm to 32mm) hole in sink top.
2. We recommend a carbide drill and to place tape over the spot where you are to drill to protect the sink or benchtop. The closer the hole is to size to tighter and more stable the fit of the faucet.

Step 5: Install Vented Faucet

1. Unscrew and remove only the Nut, Washer, Spacer & Plate (see illustration below)
2. **Above** the sink > put the faucet in the drilled hole making sure the Cover & Rubber Ring are in place
3. **Below** the sink > slide the plate up the tubes making sure not to tangle the tubes. Check colour template on P1 for correct plate orientation and tube order
4. Then slide the Spacer down the red tube making sure it is positioned in the same way it was removed. (see illustration below)
5. Next screw on the washer and hand tighten the nut
6. Using a wrench tighten 1 to 1-1/2 turns (**do not over tighten**)
7. Push spout into hole in faucet





Step 6:

Installing the Pressure Limiting Valve. (PLV)

In our 13 years experience, some water holds more sediment than others. Sediment is what causes any water filter to block up. The pressure limiting valve, installed inline on the YELLOW tube, limits pressure to the UltraStream.

If your UltraStream ceases flowing, it is because it has blocked up with sediment, and the PLV ensures it is not exposed to very high pressure from the mains supply. The 'PLV' is installed in the Yellow hose.



1. Cut the yellow hose.
2. Check flow direction. The flow must point towards to UltraStream.
3. Install the PLV by pushing each cut end of the hose into either end of the PLV.

Step 7: Install UltraStream Unit

(see John Guest Connector Usage Instructions on previous page)



1. Position the UltraStream in desired location under the sink
2. Connect the **RED** tube to the Cold water connector
3. Connect the **YELLOW** tube to the bottom of the UltraStream
4. Connect the **BLUE** tube to the top of the UltraStream using the John Guest Size Converter as pictured. *VIP! Do not push the converter further in than the clear pastic tube on the converter allows. If you do, it may cut off water flow.*
5. (Optional) Turn off the water again and cut all the tubes to adjust length (see "How to cut tubes")

To Cut or Not to Cut.

Cutting the tubes to be as neat as possible undersink may seem a good idea, but remember that if you do choose to cut them, you will not be able to easily relocate the UltraStream to benchtop for filter replacement.

For more help and support go to www.ultrastream.ws/support/

Step 7: Testing and Flush

1. Make sure Cold water connector tap is turned off.
2. Turn water ON at mains or shutoff valve.
3. Turn on Cold water connector tap and look for any leaks.
4. If a leak shows, repeat points 1-3.
5. Now turn ON the vented faucet and check again for leaks.
6. Run filter for 15-20 minutes to flush.
7. Optional: You can adjust the flow rate also by adjusting the tap at the bottom of the UltraStream (see *UltraStream manual for instructions*)
8. *If no flow...*
 - (a) *Check if the mains tap is ON*
 - (b) *Check if the yellow hose is kinked where it enters the base of the UltraStream*
 - (c) *Check that the stopvalve under the UltraStream is in the 'ON' position.*



REPLACING YOUR FILTER

UltraStream is designed to give sufficient pure water for a family of four for up to a year. Please note that this is in municipal supply conditions. It's also important to realise that any filter is a repository of toxic waste, so even though the filter may last longer, it's 'best practice' to change it within 12 months because of the possibility of buildup or propagation of bacteria in the filter. This can especially happen if you leave it unused for any period longer than a week. We recommend removing the filter and storing it in the fridge if you are going away for any significant period of time.

Remember the little white 'John Guest' Tool?

Now's the time to find it because you are going to use it. If lost, it's more difficult (but not impossible) to remove the John Guest Size Converter.

1. Turn off your mains supply under the sink and turn on the faucet to drain any excess water.
2. Using the tool, press down on the collet (grey ring) around the base of the connector. You should feel it move down under the pressure of your spanner.
3. When it moves, pull hard on the grey connector. Pliers may be needed as it can get stiff. Wiggle it a little to move it.
4. Grip the base of the UltraStream with one hand and the filter barrel with the other. Twist the filter anticlockwise to remove the filter. Take care to lift it cleanly out as you can damage the thread in the base if you are rough.



Reverse this procedure to install the new filter.

Note 1: There is no need to overtighten the new filter onto the base. Overtightening it may crack the thread and cause leaks.

Note 2: If you have not removed the round cap on top of the filter, do so. You don't get a new one with the new filter.

Note 3: DO NOT MISPLACE THE GREY JOHN GUEST CONNECTOR IN THE PROCESS OF FILTER REPLACEMENT. YOU DO NOT GET A NEW ONE WITH YOUR NEW FILTER.

VERY IMPORTANT! DO NOT TIGHTEN YOUR NEW FILTER BEYOND HAND-TIGHT! YOU MAY BREAK OFF THE THREAD. IT'S NOT NECESSARY TO BE SO TIGHT!



Like a reminder for your filter replacement? Most people forget to replace their filter within the safe time zone. Go to www.ultrastream.ws/remindme and join our free reminder service